

نقشه سنتر پایپ راکتور ۱۰۰۴

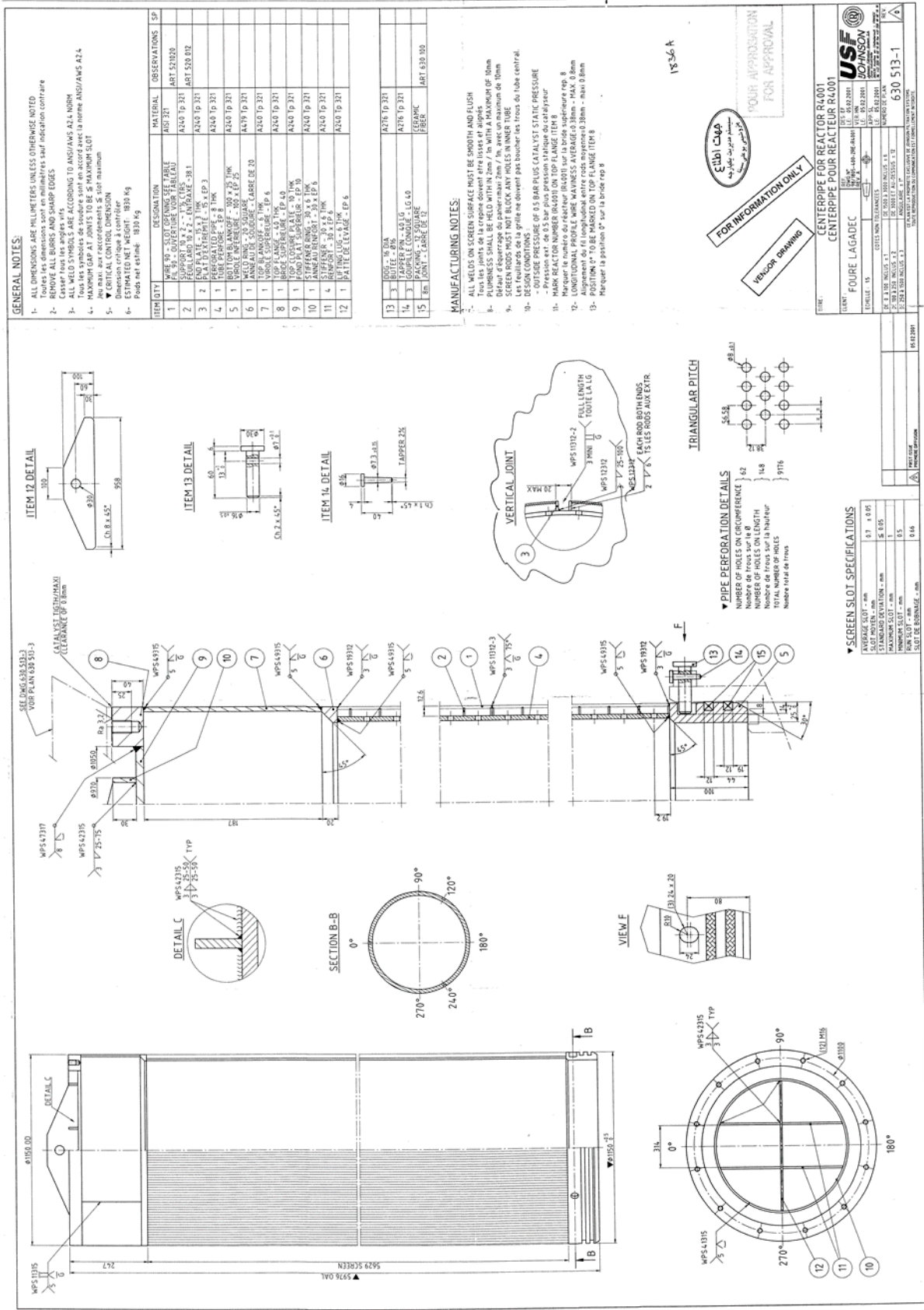

GENERAL NOTES:

- ALL DIMENSIONS ARE MILLIMETERS UNLESS OTHERWISE NOTED
Toutes les dimensions sont en millimètres sauf indication contraire
- REMOVE ALL BURRS AND SHARP EDGES
Casier tous rebords et arêtes vives
- WELDS TO BE MADE ACCORDING TO AWS/AWS A2.4 NDRM
Tous les symboles de soudure sont en accord avec la norme AWS/AWS A2.4
- MAXIMUM GAP AT JOINTS TO BE 5 MAXIMUM SLOT
au maximum au raccordement des pièces
Dimension cotage à contrôler
- ESTIMATED NET WEIGHT: 8331 Kg
Poids net estimé: 8331 Kg

ITEM ID	DESIGNATION	MATERIAL	OBSERVATIONS
1	WIRE MESH SLOTTED OPENING TABLE	ANSI 321	ART 521020
2	FLANGE	A240 TP 321	
3	FLANGE	A240 TP 321	
4	PERFORATED PIPE	A240 TP 321	
5	BOTTOM BLANKOFF	A240 TP 321	
6	INNER TUBE	A240 TP 321	
7	TOP FLANGE	A240 TP 321	
8	TOP FLANGE	A240 TP 321	
9	TOP COVER PLATE	A240 TP 321	
10	INNER TUBE	A240 TP 321	
11	DIFFERENTIAL	A240 TP 321	
12	UPPER LEG	A240 TP 321	

13	WELD	A276 TP 321	
14	WELD	A276 TP 321	
15	WELD	FRAMIC	ART 630 509

MANUFACTURING NOTES:

- ALL WELDS ON SCREEN SURFACE MUST BE SMOOTH AND FLUSH
- WELDS TO BE MADE ACCORDING TO AWS/AWS A2.4 NDRM
- FLANGES SHALL BE HELD WITHIN 2mm / in WITH A MAXIMUM OF 10mm
- DIFFERENTIAL TO BE HELD WITHIN 2mm / in, AVEC UN MAXIMUM DE 10mm
- SCREEN RODS MUST NOT BLOCK ANY HOLES IN INNER TUBE
- SCREEN RODS MUST NOT BLOCK ANY HOLES IN INNER TUBE
- SCREEN CONDITIONS grille ne doivent pas bloquer les trous de tube central
- OUTSIDE PRESSURE OF 0.5 BAR PLUS CATALYST STATIC PRESSURE
- WELD REACTION NUMBER (WRS) TO BE 100000
- LONGITUDINAL PROFILE WIRE MESHNESS AVERAGE 0.38mm - MAX 0.8mm
- ALIGNMENT OF FIT LONGITUDINAL ENTRE TROIS MOYENS 0.38mm - MAX 0.8mm
- POSITION OF FIT TO BE CHECKED ON TOP FLANGE (ITEM 8)

Marquer la position de fit sur la bride sup 8

1836A

میت اطلاع
مشاورین مهندسی پارس

FOR INFORMATION ONLY
VELOC DRAWING

YOUR APPROXIMATION FOR APPROVAL

US INDUSTRIES INTERNATIONAL

CLIENT: FOURÉ LAGADEC

PROJECT: CENTERPIPE FOR REACTOR R4001

DATE: 03/03/2011

SCALE: 1:1

FIGURE NO: 630 513-1

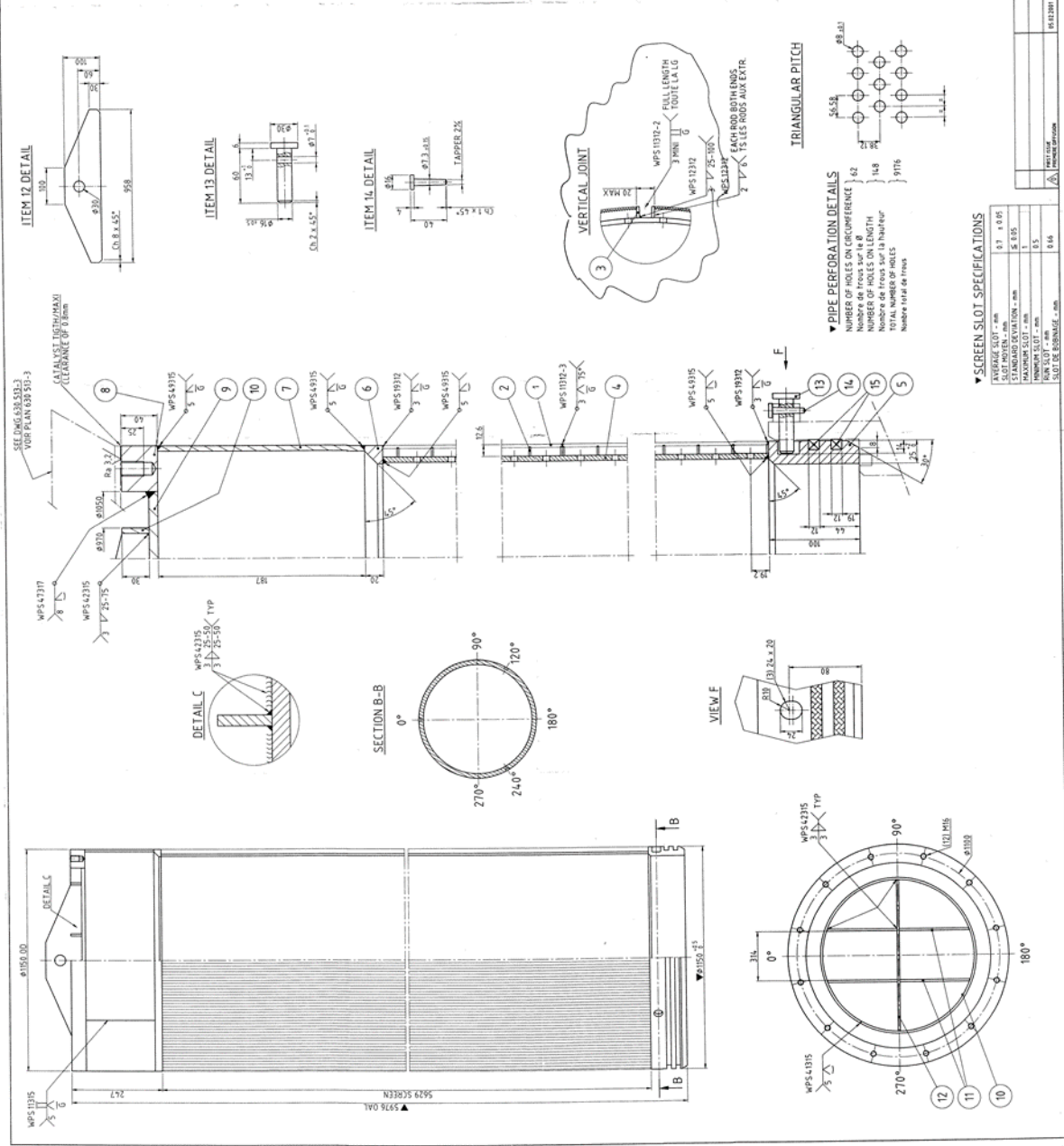

ITEM 12 DETAIL

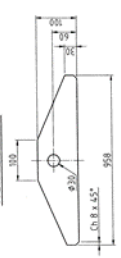

ITEM 13 DETAIL

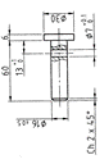

ITEM 14 DETAIL

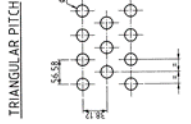
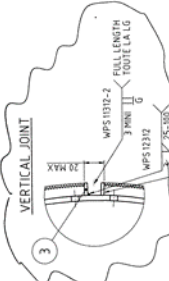
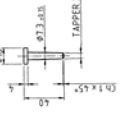

PIPE PERFORATION DETAILS

NUMBERS OF HOLES ON CIRCUMFERENCE

NUMBER OF HOLES ON LENGTH

SCREEN SLOT SPECIFICATIONS

AVERAGE SLOT	0.7	0.05
STANDARD DEVIATION	0.05	
MAXIMUM SLOT	1	
MINIMUM SLOT	0.5	
SLOT DE BARRAGE	0.14	

نقشه سنترپاپ راکتور ۲۰۰۴

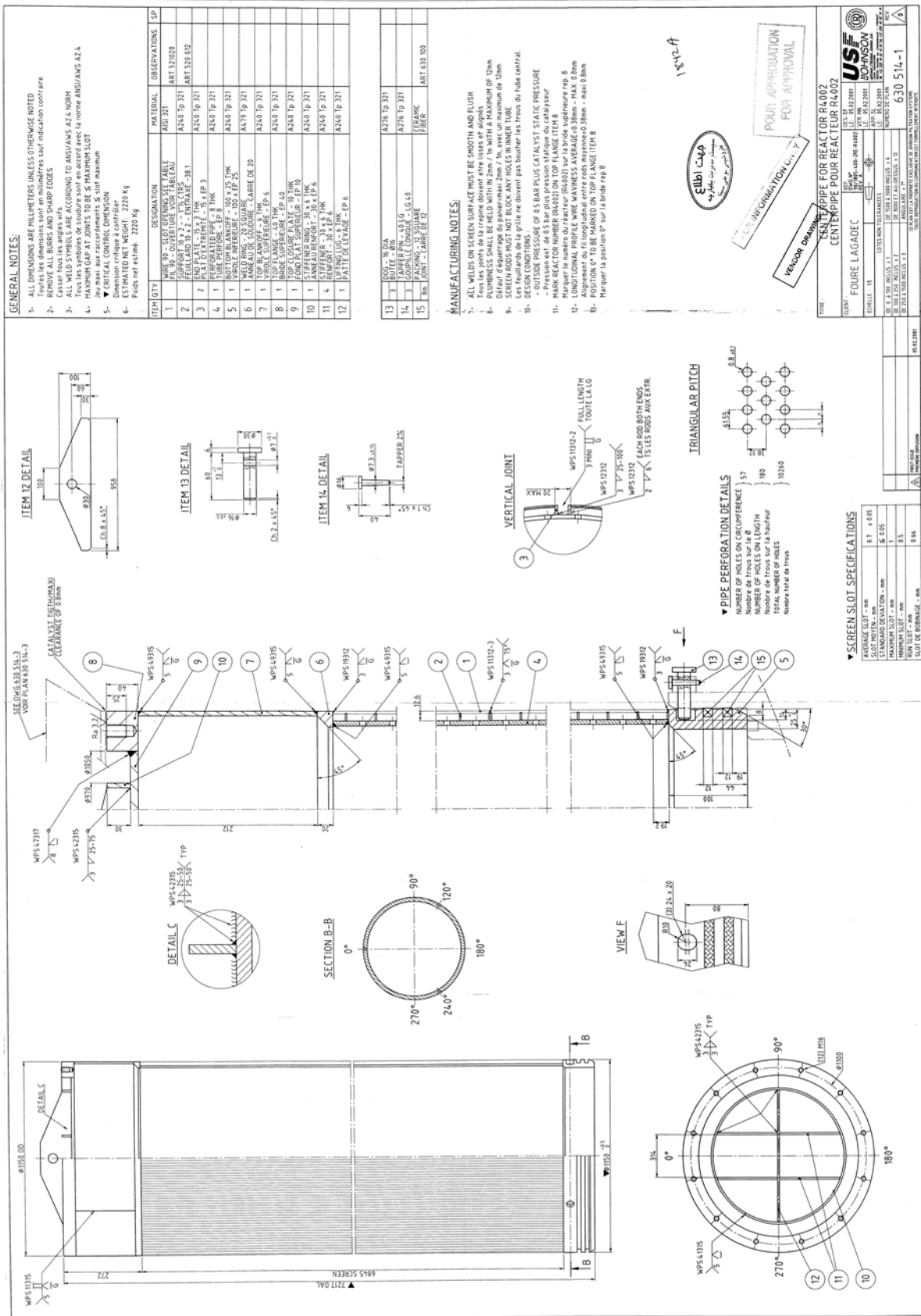

جهت اطلاع
مهندسین محترم پتروشیمی

FOR APPROVAL
POUR APPROBATION

USF JOHNSON

REACTOR CENTER PIPE FOR REACTOR R4021
CENTREPIPE POUR REACTEUR R4021

FOURE LAGADIC

DATE: 15/02/2021

PROJ: 630 S14-1

نقشه سنتر پایپ راکتور ۳۰۰۴

